

Board of Building and Fire Code Appeals

Application Form

Profile

WILLIAM

First Name

F

Middle Initial

BALLAS

Last Name

[REDACTED]

Email Address

[REDACTED]

Home Address

Suite or Apt

BURBANK

City

CA

State

91504

Postal Code

[REDACTED]

Primary Phone

[REDACTED]

Alternate Phone

RETIRED from the Los Angeles County Sanitation Districts

Employer

Public Works Construction Inspector

Job Title

RETIRED

Occupation

Which Boards would you like to apply for?

Board of Building and Fire Code Appeals: Submitted

Length of time as a Burbank Resident:

63 YEARS

Burbank Registered Voter?

Yes No

Interests & Experiences

Please tell us about yourself and why you want to serve.

Why are you interested in serving on a board, commission or committee?

TO PROVIDE THE BUILDING OFFICAL AND FIRE MARSHAL GUIDANCE & OPINIONS ON MATTERS OF THE BULIDING & FIRE CODES AND BY EXTENSION TO THE CIY COUNCIL.

Education

CONSTRUCTION INSPECTION - A.S. DEGREE - PASADENA CITY COLLEGE. GEOGRAPHY & URBAN STUDIES - B.A. - CALIFORNIA STATE UNIVERSITY, NORTHRIDGE

Additional Pertinent Courses or Training

SUCCESSFULLY COMPLETED NUMEROUS COURSES IN VARIOUS TECHNICAL FIELDS OF CONSTRUCTION INSPECTION, WITH THE RESULTS OF BEING LICENSED &/or CERTIFIED WITHIN THOSE FIELDS: PREVIOUSLY LICENSED BY THE COUNTY OF LOS ANGELES DEPARTMENT OF PUBLIC WORKS IN CONCRETE & MASONRY INSPECTION. PREVIOUSLY LICENSED BY THE CALIFORNIA DIVISION OF THE STATE ARCHITECT TO INSPECT PUBLIC SCHOOL CONSTRUCTION.

Other Pertinent Skills, Experience or Interests

APPOINTED BY THE BURBANK CITY COUNCIL TO BE A MEMBER OF THE BURBANK BOARD OF BUILDING & FIRE CODE APPEALS. I WAS APPOINTED BY THE COUNCIL ON MAY 25, 1999, AND SERVED ON THE BOARD FOR FOUR YEARS.

[Upload a Resume](#)

Community Involvement

Specify current or prior service on a City Board, Commission or Committee, listing specific the specific Board, Commission, or Committee and dates of prior service.:

MEMBER, BOARD of BUILDING and FIRE CODE APPEALS, 1999-2003

List Community activities in which you are involved:

NO ORGANIZED ACTIVITIES AT THIS TIME, HOWEVER, I DO COMMUNICATE WITH BURBANK'S COMMUNITY ASSISTANCE COORDINATORS (PAST & PRESENT) WHICH RESULTED IN EMAIL DIALOGUES BETWEEN ME AND THE CITY MANAGER & THE PUBLIC WORKS DIRECTOR ON VARIOUS MATTERS CONCERNING THE CITIZENS OF BURBANK.

If you are related to any City of Burbank employee(s), please state their name(s), relationship(s), and department(s). If you are not related to a City of Burbank employee, please put N/A.

NONE KNOWN.

Conflict of Interest

Conflict of Interest:

Rules of law and ethics prohibit members from participating in and voting on matters in which they may have a direct or indirect conflict of interest including a financial interest. Are you aware of any potential conflicts of interest which may develop from your occupation or financial holdings in relation to your responsibilities as a member of the Board, Commission or Committee to which you seek appointment?

Yes No

If you answer yes, explain in detail any potential conflicts in the same manner as required by the Fair Political Practices Commission's Statement of Economic Interests (Form 700). (If you should have any questions about this matter or need further information as it relates to your situation, please advise the City Clerk prior to submitting your application.)

AB 1234 Training

Some Boards, Commissions, and Committees may receive City reimbursement for attending trainings or conferences. Therefore, under State Law, all members of the Board of Library Trustees, Burbank Water and Power Board, Infrastructure Oversight Board, Planning Commission, and Police Commission must receive at least two hours of ethics training, as prescribed by the Fair Political Practices Commission, within one year of appointment and once every two years thereafter.

First Choice

FIRST choice for Board/Commission/Committee appointment:

BOARD OF BULIDING & FIRE CODE APPEALS.

Describe any qualifications, experience, and education, as well as any technical or professional background you may have relative to the duties of this position.

SEE ANSWERS SUPPLIED ABOVE.

What are your goals in serving on this Board/Commission/Committee?

IMPROVE CITY GOVERNMENT.

Second Choice

SECOND choice for Board/Commission/Committee appointment:

NONE

Describe any qualifications, experience, and education, as well as any technical or professional background you may have relative to the duties of this position

N/A

What are your goals in serving on this Board/Commission/Committee?

N/A

Supplemental Questions (Infrastructure Oversight Board Only)

Acknowledgment

Please Read

1. All information submitted is a public record and will be posted on the City's website.
2. All Board, Commission, and Committee members serve without compensation from the City.
3. No person shall serve at the same time on more than one Board, Commission or Committee.
4. Applicants must be residents of the City of Burbank.
5. Any person appointed to fill a vacancy shall hold office for the remainder of the unexpired term and must complete the term before applying to serve on another board, commission, or committee.
6. Any person appointed to a Board, Commission, or Committee shall remain in compliance with the City's **Attendance Policy**:
 - In the event a member of a board, commission, or committee is absent for three (3) regularly scheduled meetings of the board, commission, or committee to which they have been appointed during the 12-month period, the attendance record of such member shall be reviewed by the board, commission, or committee to which the member was appointed. Should the Council excuse the member's three absences, and the member misses a fourth meeting, the City Clerk may proceed with the member's automatic removal by City staff. (See BMC Section 2-1-403, 2-1-405, 2-1-406, 2-1-407)

I acknowledge that I have read the above, and by selecting 'Agree' I confirm that I have reviewed and understood the information above.

I Agree



JUDIE SARQUIZ
City Clerk

OFFICE OF THE CITY CLERK
CITY OF BURBANK
275 EAST OLIVE AVENUE, P.O. BOX 6459, BURBANK, CALIFORNIA 91510-6459
(818) 238-5851
FAX (818) 238-5853

May 27, 1999

William F. Ballas
[REDACTED]

Burbank, California 91504

Dear Mr. Ballas:

At its regular meeting held on May 25, 1999, the Council of the City of Burbank appointed you to be a member of the Board of Building and Fire Code Appeals for a four year term of office.

Enclosed is a copy of Section 2-414 of the Municipal Code describing the composition and duties of the Board.

You may obtain an identification card from the City Council Office (photo optional).

Before you attend a meeting of the Board of Building and Fire Code Appeals, please come to the City Clerk's Office to take your oath of office.

You are to be commended for your willingness to serve your community in this manner. It is our hope that you will find the experience personally rewarding.

[REDACTED]
JUDIE SARQUIZ
City Clerk

JS:ic

Enclosure

c: Robert M. Tague, Community Development Director



Application Form

Profile

Victor _____ **A** _____ **Taracena** _____
First Name Middle Initial Last Name

Email Address

Home Address

Suite or Apt

Burbank _____ **CA** _____ **91506** _____
City State Postal Code

Primary Phone

Alternate Phone

Self-Employed _____ **Architect/Project Manager** _____ **Architectural Consultant** _____
Employer Job Title Occupation

Which Boards would you like to apply for?

Board of Building and Fire Code Appeals: Submitted
 Burbank Water and Power Board: Submitted

Length of time as a Burbank Resident:

45 years

Burbank Registered Voter?

Yes No

Interests & Experiences

Please tell us about yourself and why you want to serve.

Why are you interested in serving on a board, commission or committee?

Having the privilege of growing up and residing in the City of Burbank for over 40 plus year has given me a unique perspective in regards to how Burbank has grown and where it must evolve too in order for the future to meet the needs of its citizenry. Having served on the Board of Building and Fire Code Appeals these past four years, i feel that i have assisted and contributed, in a positive manner, along extensive experience as a professional in architecture and construction, to the betterment of our fine city and its residents through service.

Education

I hold a bachelors degree in Architectural Design from Woodbury University. Additionally, I have taken Advance course work in Plumbing Engineering and Design from UCLA's Extension Program.

Additional Pertinent Courses or Training

I have taken the following course work to continually stay current with current design and construction trends and technologies: The National Programme on Technology Enhanced Learning Diploma in the Fundamental of Landscape Architecture The National Programme on Technology Enhanced Learning Diploma in Contemporary Architecture and Design The National Programme on Technology Enhanced Learning Advanced Diploma in Sustainable Architecture Hollow Metal Manufacturers Association Understanding Fire Rated Openings Clark Dietrich Systems & Cold Form Steel Framing Connections The State of California Architectural Board (CAB) Continuing education course work on ADA compliance

Other Pertinent Skills, Experience or Interests

Upload a Resume

Community Involvement

Specify current or prior service on a City Board, Commission or Committee, listing specific the specific Board, Commission, or Committee and dates of prior service.:

Currently serving on the Board of Building and Fire Code Appeals (07/15/2022 - 07/16/2026)

List Community activities in which you are involved:

Recently Graduate from the City's R.I.S.E. Program 2025 Participated in the City Sponsored Earth Day 2025

If you are related to any City of Burbank employee(s), please state their name(s), relationship(s), and department(s). If you are not related to a City of Burbank employee, please put N/A.

N/A

Conflict of Interest

Conflict of Interest:

Rules of law and ethics prohibit members from participating in and voting on matters in which they may have a direct or indirect conflict of interest including a financial interest. Are you aware of any potential conflicts of interest which may develop from your occupation or financial holdings in relation to your responsibilities as a member of the Board, Commission or Committee to which you seek appointment?

Yes No

If you answer yes, explain in detail any potential conflicts in the same manner as required by the Fair Political Practices Commission's Statement of Economic Interests (Form 700). (If you should have any questions about this matter or need further information as it relates to your situation, please advise the City Clerk prior to submitting your application.)

AB 1234 Training

Some Boards, Commissions, and Committees may receive City reimbursement for attending trainings or conferences. Therefore, under State Law, all members of the Board of Library Trustees, Burbank Water and Power Board, Infrastructure Oversight Board, Planning Commission, and Police Commission must receive at least two hours of ethics training, as prescribed by the Fair Political Practices Commission, within one year of appointment and once every two years thereafter.

First Choice

FIRST choice for Board/Commission/Committee appointment:

Fire and Building Appeals Board

Describe any qualifications, experience, and education, as well as any technical or professional background you may have relative to the duties of this position.

I hold a bachelors in Architectural Design from Woodbury University and advanced coursework in Plumbing Engineering Design from UCLA Extension. Additionally I was an adjunct professor, teaching undergraduates and continuing education course work at the University of Rafael Landivar in Guatemala Central America, where i focused on teaching the 2nd through 5th year students on design theory, construction documents, wood and steel design analysis. I taught the use of ecological wood and Light gauge steel framing (CFS-Cold Formed Steel), to architects and engineers.

What are your goals in serving on this Board/Commission/Committee?

I wish to bring my experience and technical knowledge to the board in taking actions and making decisions that will serve the City of Burbank and by extension its citizens.

Second Choice

SECOND choice for Board/Commission/Committee appointment:

Water and Power Board

Victor A Taracena

Describe any qualifications, experience, and education, as well as any technical or professional background you may have relative to the duties of this position

I hold a bachelors in Architectural Design from Woodbury University and advanced coursework in Plumbing Engineering Design from UCLA Extension. Additionally I was an adjunct professor, teaching undergraduates and continuing education course work at the University of Rafael Landivar in Guatemala Central America, where i focused on teaching the 2nd through 5th year students on design theory, construction documents, wood and steel design analysis. I taught the use of ecological wood and Light gauge steel framing (CFS-Cold Formed Steel), to architects and engineers.

What are your goals in serving on this Board/Commission/Committee?

I wish to bring my experience and technical knowledge to the board in taking actions and making decisions that will serve the City of Burbank and by extension its citizens.

Supplemental Questions (Infrastructure Oversight Board Only)

Acknowledgment

Please Read

1. All information submitted is a public record and will be posted on the City's website.
2. All Board, Commission, and Committee members serve without compensation from the City.
3. No person shall serve at the same time on more than one Board, Commission or Committee.
4. Applicants must be residents of the City of Burbank.
5. Any person appointed to fill a vacancy shall hold office for the remainder of the unexpired term and must complete the term before applying to serve on another board, commission, or committee.
6. Any person appointed to a Board, Commission, or Committee shall remain in compliance with the City's **Attendance Policy**:
 - o In the event a member of a board, commission, or committee is absent for three (3) regularly scheduled meetings of the board, commission, or committee to which they have been appointed during the 12-month period, the attendance record of such member shall be reviewed by the board, commission, or committee to which the member was appointed. Should the Council excuse the member's three absences, and the member misses a fourth meeting, the City Clerk may proceed with the member's automatic removal by City staff. (See BMC Section 2-1-403, 2-1-405, 2-1-406, 2-1-407)

I acknowledge that I have read the above, and by selecting 'Agree' I confirm that I have reviewed and understood the information above.

I Agree

Victor A Taracena

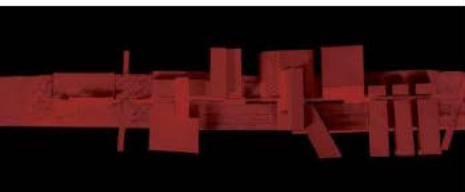

Victor A. Taracena

Professional Curriculum Vitae

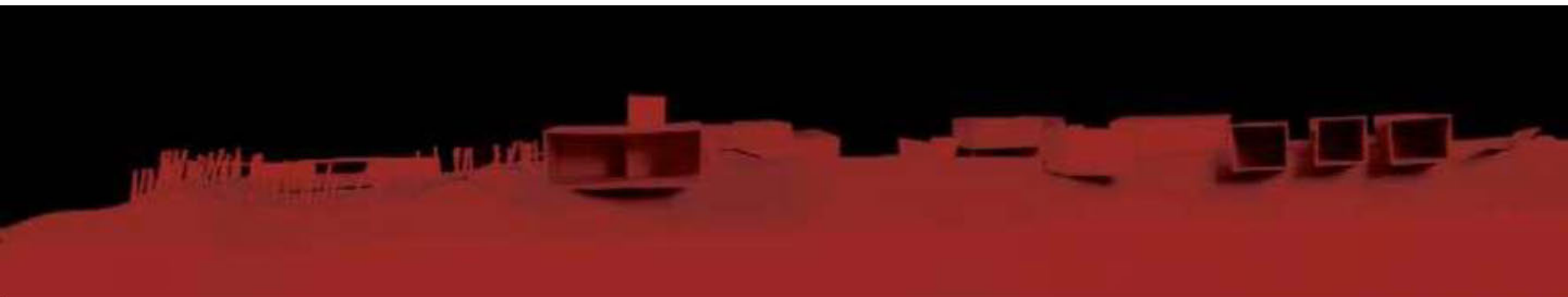

Victor A. Taracena

Professional Curriculum Vitae

Table of Contents



RESUME



STUDENT



PROFESSIONAL



ACADEMIC



SEMINARS - PUBLICATIONS - AWARDS





RESUME

Residency:  Burbank CA 91506

Telephone: 

Email: 

Education: **UCLA - Extensions**
Plumbing Engineering Systems

Woodbury University
Bachelors in Architectural Design (B.Arch)

Glendale Community College
Architectural Drafting & Design

**The National Programme on Technology
Enhanced Learning**
Diploma in the Fundamental of Landscape Architecture

Education:

The California Building Official Training
Means of Egress, A Detailed Analysis,

The California Building Official Training
ADA/Title 24-Accessibility Provisions for Alterations &
Remodels in Existing Buildings

The California Building Official Training
Simplified Engineering: The Design of Wood Structures

Georgia - Pacific
Finding Design and Construction Efficiencies with
Integrated Weather Barrier System

Cemco - Steel Framing Co.
Design, Engineering of exterior metal curtain wall
Systems for mid-rise commercial structures





RESUME

Education: **The National Programme on Technology
Enhanced Learning**
Diploma in the Fundamental of Landscape Architecture

**The National Programme on Technology
Enhanced Learning**
Diploma in Contemporary Architecture and Design

**The National Programme on Technology
Enhanced Learning**
Advanced Diploma in Sustainable Architecture

Hollow Metal Manufacturers Association
Understanding Fire Rated Openings

Clark Dietrich Systems
Cold Form Steel Framing Connections:





RESUME

**Employment: Commissioner for the Fire & Building Appeals Board City of Burbank
July 2022 - Current, Burbank, CA**

To hear and determine appeals from decisions of the Assistant Community Development Director - Building Official regarding the suitability of alternative materials and types of construction required by the Building Code and interpretations of the Building Code,

To hear and determine appeals from any decision, order to notice signed or renewed by the Fire Marshal regarding the suitability of alternate materials, methods of construction, or operation under the Fire Code and interpretations of the Fire Code;

To prepare and recommend for adoption by the City Council, rules and regulations for the conduct of its hearings and investigations;

To recommend for adoption by the City Council, a schedule of fees for appeals to the Board; and,

To recommend to the City Council, amendments to the Building Code or Fire Code

**Employment: Commissioner for the Burbank Unified School District - SFOC
Oct 2025 - Current, Burbank, CA**

Responsible to review monthly expenditure reports of construction, modernization and/or renovation funds
Review progress reports of ongoing construction, modernization and/or renovation projects, including bond funded projects on a monthly basis

To inspect under the supervision of the Superintendent of Facilities all school sites where bond proceeds have been or will be expended in accordance and compliance with Article XIII A, Section 1(b)(3) of the California Constitution and D.S.A (Department of State Architect) Standards

Review and provide recommendations regarding the District's efforts to maximize bond proceeds by implementing cost-saving measures, including but not limited to: (1) mechanisms designed to reduce costs of professional fees; (2) mechanisms designed to reduce costs of professional fees; (3) mechanisms to provide alternate & efficient school design





RESUME

Employment: Senior Project Architect
BayShore Engineering &
General Contractor
A Division of BC, Inc
November 2015 - Current Claremont, CA

Provided residential clients with schematic designs to formal construction documents for room additions, second story additions and ADU structures (Stand alone & Garage conversions),
Provide detailed cost estimates and contract specifications for clients review,
Interact with local building department plan check and zoning divisions to ensure construction document approval,
Provide translation of construction documents into Spanish for on-going projects in Mexico, and Central America,
Provide quality control inspections to ensure compliance with scope of work, construction specifications, and contract documents,
Interact with clients to address construction progress and miscellaneous questions.

Employment: Technical Advisor
(Architectural Materials) Grupo Taracena
A Division of Lenny's Enterprises,
February 2002 - 201 Guatemala, GUA

Imported Light Gauge Steel Framing components, drywall and associated materials for house construction and commercial use,
Provided technical assistance in the integration of light gauge steel framing products into ongoing projects,
Provided technical seminars to local professionals and universities on the merits of using imported construction materials in their respective projects,
Provide quality control inspection services for on going projects,
Worked with local customs processing all shipping containers, Bills of Lading, and the integration of revised tariffs under the treaties of NAFTA and CAFTA.



RESUME

**Employment: Adjunct Architectural Professor
University of Rafael Landivar -
School of Architecture
February 2010 - 2012 Guatemala, GUA**

Prepared syllabus outlining course and content with measurable metrics and outcomes for Design Studio, Method and Materials, and all other related courses,

Imparted Design classes in wood and structural steel which included topics like design analysis, hybrid design and how green building philosophies can be implemented into building designs,

Imparted Design Studio classes where multi-variant architectural philosophies are studied and discussed with eventual implementation through fictitious projects and in some cases through international design competitions, where concepts like scale, massing, orientation, structure and urban context are used to synthesize and propose a design solution to a specific set of variables which encompassed the project solution,

Imparted materials and methods classes in system integration of Mechanical, Electrical, plumbing (MEP) systems in wood and steel structures for a mixed class of 3rd & 4th year students,

Imparted classes in wood & steel structural design and analysis with emphasis on seismic considerations and the application of structural considerations and their impact on architectural pre-design and design process.

**Employment: Adjunct Architectural Professor
Continuing Education program
University of Rafael Landivar -
School of Architecture
February 2010 - 2012
Guatemala, GUA**

Created curriculum and training program for the design and detailing of light gauge steel framing in multi-story residential, multi-story commercial and curtain wall design for light commercial construction as a viable alternative to traditional building construction methods,

Created curriculum and training program for the design and detailing of wood framing in multi-story residential, multi-story commercial and design for light commercial construction as a viable alternative to traditional building construction methods, with special emphasis on the ecological aspects of using engineered lumber





STUDENT

Reinterpreting the Glass House (2nd Year- 3 week Design Charrette)

Design a house for a working couple with no children for a vacant site in Palo Alto CA.

I integrated a public restaurant into the private home to study the interactions and mutual subversions of convention that would occur between the domestic and commercial urban spaces. I studied glass house precedents and externalized aspects of domestic life that relies on and interacts with ideas of transparency, opaqueness and the liminal space in between.



STUDENT

Case Study of an Open Air Pavilion

The assignment was to study the assigned existing building and present the analysis to the class. I researched the architect and the specific project to focus our analysis on the most formally and structurally relevant aspects of the design.

We modeled the building at 1/4" in a partially completed wooden model to better explore the essential structural system.



STUDENT

INTERVENTION AT CHEROKEE PARK

Intended for year-round use as a retreat for one to two people. The building is completely self-sufficient, detached from any county or rural utilities. The design was driven by a desire for the building harmonize with nature. The small interior (392 sq. ft.) is supplemented by a variety of outdoor spaces which increase the sense of spaciousness, while fulfilling programmatic requirements.

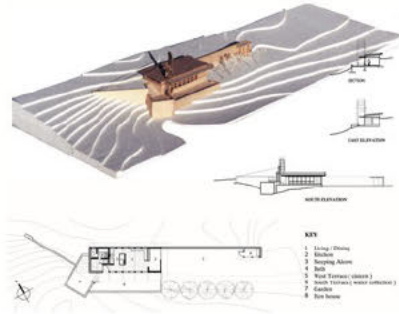

PROFESSIONAL

SKATE GARAGE

This project came out of a concern for local community, that kids are spending too much time inside. I proposed to design an appropriate architecture for adolescent leisure in the city, suggesting that this architecture would integrate youths' everyday lives into the public realm by interfacing their spaces with spaces for adult generations. The project morphed into the design of a parking garage in Uptown Minneapolis, one that concurrently offers parking and provides opportunities for adolescents to freestyle skate. A bike shop and a snack store were incorporated to interface older generations into this adolescent realm.

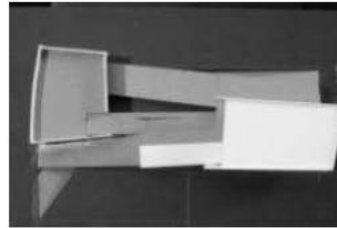
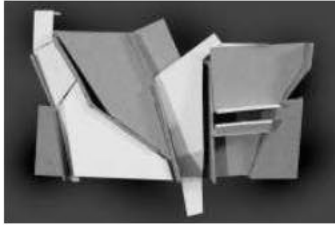

Construction Detailing

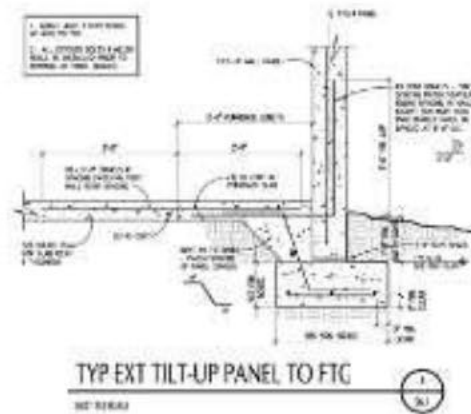
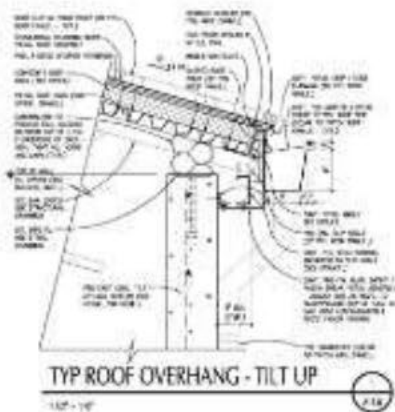



PROFESSIONAL

Project Management of a Community Center for The Church of the Sacred Water in San Miguel Duenas, Antigua Guatemala that involved the design and supervised installation of a multi-story curtain wall system with a Parex exterior coating.



PROFESSIONAL

Supplied materials and technical assistance for a 2,500 square meter shopping Center in Zona 18 of Guatemala City, Guatemala for the Developer—Grupo Rosul that involved a framed in wall stud stud systems utilizing light gauge steel framing with structural shearwalls.



PROFESSIONAL

Designed and Constructed Mobile field for Rio Tinto S.A., consisting of 56 Square meter steel framed structure – San Jose Pinula, Guatemala.



ACADEMIC

Cursos Libres Landívar
Diseño y Construcción Ecológico en Madera (sistema nacional e internacional)
Para todo público



Días sábado: del 28 de abril al 16 de junio
Horario: de 10:00 a 13:00 horas
Lugar: Universidad Rafael Landívar
Inversión: Q 850.00

Cupó limitado

Catedrático: Arq. Víctor Taracena

Mayor información:
Centro Landívar de Educación Continua
Teléfono: 2405-2544 o 2405-2622
Correo electrónico: cursoslibres@ul.edu.gt y
www.ul.edu.gt/cursoslibres
www.facebook.com/cursoslibreslandivar



Cursos Libres Landívar
Diseño y Construcción de Estructuras Livianas de Acero (sistema internacional)
Para todo público



Días sábado: del 28 de abril al 16 de junio
Horario: de 8:00 a 10:30 horas
Lugar: Universidad Rafael Landívar
Inversión: Q 850.00

Cupó limitado

Catedrático: Arq. Víctor Taracena

Mayor información:
Centro Landívar de Educación Continua
Teléfono: 2405-2544 o 2405-2622
Correo electrónico: cursoslibres@ul.edu.gt y
www.ul.edu.gt/cursoslibres
www.facebook.com/cursoslibreslandivar



2011

PROFESORADO DEL CURSO 2011
Arq. Víctor Taracena, Taracena, V.C., Ph.D.
Hogar: Amato, Taracena, Q.G., 240



Introducción al sistema constructivo de estructuras livianas de acero LIGHT GAUGE STEEL FRAMING

INTRODUCCION AL SISTEMA CONSTRUCTIVO: ESTRUCTURAS LIVIANAS EN ACERO LIGHT GAUGE STEEL FRAMING

La introducción al sistema constructivo de estructuras livianas de acero LIGHT GAUGE STEEL FRAMING es un curso de introducción a este sistema constructivo. El curso tiene como objetivo proporcionar al participante los conocimientos necesarios para el diseño y la construcción de estructuras livianas de acero LIGHT GAUGE STEEL FRAMING.

Universidad Rafael Landívar **GRUPO TARACENA**
Visión de Leones | Determinación

La Facultad de Arquitectura de la Universidad Rafael Landívar y Grupo Taracena le invita a la conferencia

Steel Framing Building System

Un método de construcción nuevo en Guatemala utilizado desde hace mucho tiempo en EEUU

Lugar:
Km. 25 Car. A San José Pinula "La De Volcan", Lote 5, No. 1-11

Horario:
09:30 horas

Continuar asistencia:
gruposocial@gmail.com
Tel. 5137-1724

Fecha:
Sábado 02 de Septiembre



ACADEMIC

Estructura Liviano de Acero (ELA) de alta rendimiento

Una Introducción a lo mas avanzado en Sistemas Constructivos para:



Presentado por:



Introducción a las Estructura Liviano de Acero (ELA)

El Ambiente **Acero**

una material ambientalmente amistosa :

- ✓ Por cada tonelada de acero que se recicla, se conserva 2,500 libras de hierro, 1400 libras de carbón, y 120 libras de piedra de caliza.
- ✓ Una casa de acero llena **2 pies cúbicos** de escombros en un vertedero comparado a 50pies cúbicos de escombros de una casa de madera y 85 pies cúbicos de una casa de bloque (tradicional)
- ✓ Menos de 6% de acero esta en los vertederos



Facultad de Arquitectura

Sa. Avenida 9-00 Zona 2,
Interior Finca El Zapote
Ciudad de Guatemala, Guatemala, C.A.

Porque Steel Framing?

Forma de Construcción de Steel Frame



Porque Steel Framing?

- ▶ **Durabilidad** - Una de las ventajas más evidentes de utilizar acero sobre madera o bloques de hormigón en la construcción residencial y comercial es la durabilidad. Mientras que el acero es mucho más fuerte que los productos de madera, hay otras ventajas de durabilidad también. En lo que respecta a la construcción de bloques de hormigón que tiene mejores valores térmicos y una mayor flexibilidad estructural y diseño. La madera es susceptible a las termitas y otras plagas, mientras que el acero no. Steel también ofrece una estructura con mayor resistencia en el caso de terremotos, incendios y otros desastres naturales.
- ▶ **Diseño** - Arquitectos, diseñadores y constructores están encontrando muchas ventajas al uso de acero sobre la madera en la construcción residencial en Massachusetts. Una de las oportunidades más beneficiosas es la capacidad de abarcar mayores distancias con las vigas del techo de acero frente a las de madera. Esto permite a los arquitectos para ampliar sus opciones, que les permite crear nuevo espacio utilizando los productos de acero que simplemente no están disponibles con otros materiales.

Cambios Técnicos

▶ **No solo cambiamos el nombre pero cambiamos la designación de calibre y como se identifica**

El Viejo forma de identificar un poste o canalita: **2 1/2" x 8'-0" de calibre 20**

El Nuevo formato: **250I125-30 (Mills)**



SEMINARS - PUBLICATIONS - AWARDS

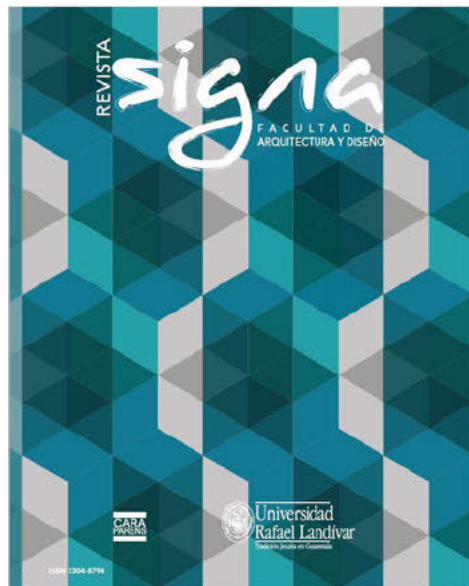

El movimiento de la "arquitectura natural" apunta a separar los conceptos de "land art" usualmente entendido como formas de intervención en el lugar de la protesta (esta nueva filosofía arquitectural tiene como objetivo captar la relación armoniosa de la naturaleza modificada con la acción de la humanidad y la naturaleza resultando en espacios arquitectónicos).

El concepto central del movimiento es que la humanidad pueda vivir en armonía con la naturaleza al mismo tiempo buscando un balance entre la naturaleza y el mundo de la humanidad. El movimiento se caracteriza por el trabajo de una serie de artistas, diseñadores y arquitectos que expresan estos principios en su trabajo. Los países son sencillos, humildes y memorables celebrando la mayoría de las estructuras básicas de la naturaleza y aplicando conocimientos sencillos de construcción. De todo lo que se ha hecho se inspira a la arquitectura indígena. Es que refleja el deseo de volver a un mundo menos tecnológico. Las formas son desiguales hasta su esencia, expresando la belleza natural inherente en los materiales y la ubicación. El movimiento tiene muchas formas de expresión que se desarrollan en la localización (sitio), estructuras construidas con materiales del área y muchos casos débiles vivos. Sin embargo, todos los tipos de este movimiento muestran un interés y aprecio por la naturaleza. Estas obras tienen por objetivo hacer un movimiento volver a arquitectura y ofrecer de un nuevo enfoque filosófico de los edificios y estructuras. Su objetivo es crear estructuras que sean arquitectónicas, que comiencen en una forma sencilla que la naturaleza debe ser un reflejo de la arquitectura. Sin embargo, los materiales naturales se ajustan deliberadamente armonioso al proceso de construcción. Vemos las ramas, las hojas y todos los elementos por los que nos inspiramos que estas estructuras no existen para siempre, sino materiales que se evolucionan con el tiempo, con el fin de establecer posición antes hasta que no quede evidencia

de la existencia. Estas características son intencionalmente provocando a los espectadores a cuestionar los convencionalismos y filosofías establecidas de arquitectura-tiempo, permanencia, simetría, monumentalidad. Los arquitectos que impulsan estas filosofías no están sugiriendo que la arquitectura debe ajustarse a la visión, también no están sugiriendo que debemos abandonar nuestro mundo que hemos construido, solo quieren propiciar ideas y estimular conversaciones que nos inspiren a volver a explorar la relación entre la naturaleza al medio ambiente construido y nuestra humanidad. Pienso que debemos escuchar.



Revista Signa 19
Año 1998, No. 1



Revista Signa 19
Año 1998, No. 1



Revista Signa
Año 1998, No. 1

SEMINARS - PUBLICATIONS - AWARDS

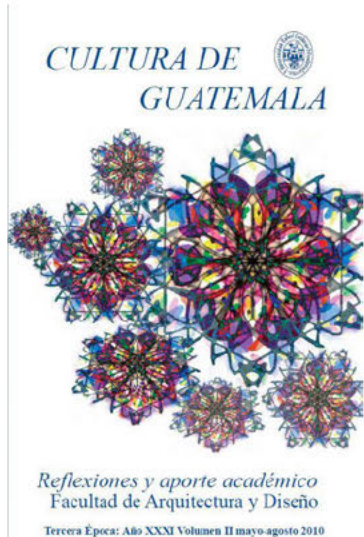

Arquitectura verde

Arq. Victor Tarazona
Catedrático Woodbury University USA

¿Qué exactamente es la arquitectura verde?

Arquitectura verde es un enfoque de la construcción que se ha vuelto más frecuente en los últimos 25 a 30 años. También conocido como diseño sostenible, la arquitectura verde es simplemente un método de diseño que minimiza el impacto de la construcción sobre el medio ambiente. Una vez considerados como no convencionales y no-estándar, la arquitectura ecológica se está convirtiendo rápidamente aceptado por las dos agencias reguladoras y el público en general como un medio socialmente responsable y lógico de la construcción.

Los comienzos de la actual revolución verde se remontan a la conciencia social de la década de 1960 y el diseño europeo, como se encuentra en Escandinavia. A partir de estos orígenes, nuevas técnicas de construcción han llevado al desarrollo de materiales innovadores y conceptos de diseño. En efecto, diseñado con éxito los proyectos ecológicos pueden incluir una amplia gama de factores, que van desde el uso de recursos de materiales, a un cuidadoso examen de la función, el clima, y ubicación.

Entonces, ¿qué hace que algo sea "verde"?

Los conceptos de la arquitectura verde en general, se pueden organizar en varias áreas de aplicación. Estas áreas incluyen la sostenibilidad, los materiales, la eficiencia energética, uso de la tierra, y la reducción de residuos.

55

Arquitectura verde

residuos mediante el uso de reciclado de aguas grises y otras estrategias de energía sostenible.

Uso de la tierra

La selección del sitio y la orientación del edificio también desempeñan un papel crítico en el diseño de cultura verde. Un edificio verde es ubicado para aprovechar su clima y sus alrededores. Estas condiciones no sólo afectan a la eficiencia de un edificio, sino a la comunidad y la sociedad en su conjunto. En la planificación para el uso responsable de la tierra se tratan estas cuestiones a través de la consideración del clima, el transporte y el medio ambiente natural.

Reducción de residuos

Es asombrosa la cantidad de residuos generados por la construcción de un edificio típico. Los edificios verdes están diseñados para eliminar los residuos mediante el uso de sistemas modulares de construcción, productos reciclados, y el uso eficiente de los materiales. El edificio verde ideal sería no crear ningún desecho, ya sea durante la construcción o el uso, por lo que el impacto sobre el medio ambiente y los recursos se reduce al mínimo.

Resumen

Hay un día, el diseño sostenible se está convirtiendo en una parte natural de un número cada vez mayor de los edificios. Como los recursos naturales disminuyen, diseño verde tendrá un papel fundamental en nuestro medio ambiente construido. Como arquitectos, tenemos una obligación con la sociedad para actuar como buenos custodios de este planeta mediante el desarrollo y la aplicación de las filosofías de diseño sostenible que buscan mejorar la calidad del entorno construido, reduciendo al mínimo o incluso eliminar los efectos negativos para el medio ambiente natural.

57

SEMINARS - PUBLICATIONS - AWARDS

Detalles Constructivos e Información Técnica
Para
El Diseño, Especificación, Utilización y Construcción
de
Estructural Formado en Frio (CFS)
(Cold Formed Steel)



Preparado por el Arq. Víctor A. Taracena, SFA, SSMA, USGBC,

Publicación técnica para uso académico a través de:



La información contenida dentro de este expediente es para informar e instruir. El Arquitecto, Ingeniero o Constructor debe consultar al Productor, Distribuidor o profesional certificado en el diseño de Acero Formado en Frio (CFS) para asegurar el uso correcto del material. Grupo Taracena no se hace responsable por el uso incorrecto de la información presentada dentro de este expediente.

1

Montaje del Entrepiso

Se preparan las vigas de entrepiso según su medida verificando también que la distancia total, entre paneles exteriores opuestos coincida con la medida de los planos. Se procede al corte de las mismas a la medida requerida. Así mismo se preparan los rigidizadores y los perfiles "L", que se utilizarán para la correspondiente fijación de la viga al panel. Primero se colocarán las soleras de cierre y posteriormente las vigas de entrepiso. Es muy importante recordar la colocación de los entenas en los apoyos de las vigas y bajo muros de carga, para evitar el abollamiento del albañil.

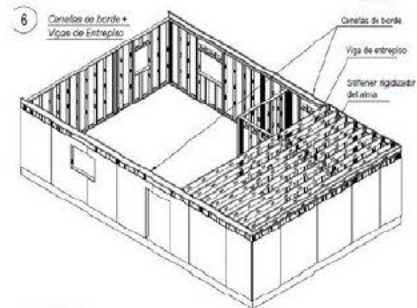

Deberán preverse los espacios destinados a vanos en el entrepiso.

92

SEMINARS - PUBLICATIONS - AWARDS



La Universidad Rafael Landívar a través de su Departamento de Arquitectura

Otorgan el presente reconocimiento
al grupo ganador de estudiantes de Proyectos Arquitectónicos,
con la selección de la propuesta para la elaboración e instalación de

“Folies Commemorativos a los

50 años de la Universidad Rafael Landívar”.

Guatemala, 10 de febrero de 2011



Otorga el presente Diploma a:

Arq. Victor A. Taracena

Por su participación en el

SEMINARIO TÉCNICO “DISEÑO DE PUENTES FLUVIALES” (Aplicación e Importancia del Análisis Hidrológico, Hidráulico y Geotécnico en el diseño de Puentes Fluviales)

Impartido por el Dr. Robert Ettema Decano de la Facultad de Ingeniería y Ciencias Aplicadas
de la Universidad de Wyoming y por reconocidos expositores Nacionales
realizado del 10 al 14 de enero del año 2011, en la Ciudad de Guatemala



SEMINARS - PUBLICATIONS - AWARDS

Universidad del Valle de Guatemala



Conferencia: Sistemas Constructivos
Uso & Aplicación de la Madera como Sistema Constructivo Sostenible en Guatemala

Fecha: 29 de Julio 2011
Hora: 3:00 pm a 5:00 pm
Lugar: Auditorium F-101
Ultimo dia para inscribirse: 26 de julio

Más información:
Departamento de Ingeniería Civil
Engrain Barillas
Teléfono: 2364-0316 Ext. 546 y 574
Correo electrónico: ebarillas@uvg.edu.gt

Patrocinado por:



Conferenciista:
El Arq. Victor A. Taracena, un arquitecto americano con 20 años de experiencia en el sistema constructivo en madera. Cuenta con experiencia como inspector de edificios & vivienda para el Departamento de Planificación & Edificación de la Ciudad de Long Beach y como Director del departamento de Diseño & Construcción para el Departamento de Desarrollo Habitacional y Urbano de los EOUJ. Actualmente es co-propietario de Grupo Taracena, una compañía importador de productos de construcción certificados LEEDS por USGBC.



**UNIVERSIDAD
MARIANO GÁLVEZ**

POR MEDIO DE LA
FACULTAD DE ARQUITECTURA
PRÁCTICA PROFESIONAL SUPERVISAD PPS
ENTREGA EL SIGUIENTE RECONOCIMIENTO
AL SEÑOR:

Arq. Victor A. Taracena

POR SU PARTICIPACIÓN EN EL TALLER BASADO EN EL SISTEMA
CONSTRUCTIVO STEEL FRAMING
CELEBRADO EL VIERNES 2 DE OCTUBRE DEL PRESENTE AÑO



COORDINACIÓN DE
PRÁCTICA PROFESIONAL SUPERVISADA



SEMINARS - PUBLICATIONS - AWARDS



SEMINARS - PUBLICATIONS - AWARDS



Board of Education
Dr. Urmasid Aghaizadeh, President
Abby Pontzer-Karskar, Vice President
Dr. Emily Weisberg, Clerk
Laurette Lano

Burbank Unified School District
Facilities Services
510 S. Shelton St
Burbank, CA 91506
Ph: 818-779-5502 • Fax: 818-779-3484

Interim Superintendent
Oscar Macias, Ed.D.

October 6, 2025

Victor Taracena

Burbank, CA 91506

It is with great pleasure that I inform you, on behalf of the Board of Education of the Burbank Unified School District, that at its regular meeting on September 18, 2025, you were appointed to serve on the School Facilities Oversight Committee. The duration of your term will be determined and established during the meeting.

You will receive notice of meeting times and dates by the District's Facilities Services Office. Thank you for your interest in serving on the Committee and for your support of the Burbank Unified School District.

Sincerely,

Oscar Macias
Interim Superintendent

c Board of Education
Facilities Services

Application Form

Profile

Christopher _____ Castro _____
 First Name Middle Initial Last Name

_____ _____
 Email Address

_____ _____
 Home Address Suite or Apt

Burbank _____ CA _____ 91502 _____
 City State Postal Code

_____ _____
 Primary Phone Alternate Phone

Self Employed _____ Surety Agent _____ Insurance _____
 Employer Job Title Occupation

Which Boards would you like to apply for?

Board of Building and Fire Code Appeals: Submitted
 Landlord-Tenant Commission: Submitted

Length of time as a Burbank Resident:

53

Burbank Registered Voter?

Yes No

Interests & Experiences

Please tell us about yourself and why you want to serve.

Why are you interested in serving on a board, commission or committee?

As a lifelong resident I want to use my professional experience to serve the City wherever needed

Education

Notre Dame HS LA Valley College CSUN

Additional Pertinent Courses or Training

I hold many certifications in construction, insurance and legal education.

Other Pertinent Skills, Experience or Interests

I am a construction, insurance and Property Management expert with over 25 years experience.

[Upload a Resume](#)

Community Involvement

Specify current or prior service on a City Board, Commission or Committee, listing specific the specific Board, Commission, or Committee and dates of prior service.:

Former Building and Fire Code Appeals Board

List Community activities in which you are involved:

I am involved in many charity opportunities and active in my church

If you are related to any City of Burbank employee(s), please state their name(s), relationship(s), and department(s). If you are not related to a City of Burbank employee, please put N/A.

No

Conflict of Interest

Conflict of Interest:

Rules of law and ethics prohibit members from participating in and voting on matters in which they may have a direct or indirect conflict of interest including a financial interest. Are you aware of any potential conflicts of interest which may develop from your occupation or financial holdings in relation to your responsibilities as a member of the Board, Commission or Committee to which you seek appointment?

Yes No

If you answer yes, explain in detail any potential conflicts in the same manner as required by the Fair Political Practices Commission's Statement of Economic Interests (Form 700). (If you should have any questions about this matter or need further information as it relates to your situation, please advise the City Clerk prior to submitting your application.)

AB 1234 Training

Some Boards, Commissions, and Committees may receive City reimbursement for attending trainings or conferences. Therefore, under State Law, all members of the Board of Library Trustees, Burbank Water and Power Board, Infrastructure Oversight Board, Planning Commission, and Police Commission must receive at least two hours of ethics training, as prescribed by the Fair Political Practices Commission, within one year of appointment and once every two years thereafter.

First Choice

FIRST choice for Board/Commission/Committee appointment:

Landlord Tenant

Describe any qualifications, experience, and education, as well as any technical or professional background you may have relative to the duties of this position.

I have 25 years property management experience.

What are your goals in serving on this Board/Commission/Committee?

To serve at the pleasure of the City Council and the resident of Burbank however my experience is needed

Second Choice

SECOND choice for Board/Commission/Committee appointment:

Describe any qualifications, experience, and education, as well as any technical or professional background you may have relative to the duties of this position

What are your goals in serving on this Board/Commission/Committee?

Supplemental Questions (Infrastructure Oversight Board Only)

Acknowledgment

Please Read

1. All information submitted is a public record and will be posted on the City's website.
2. All Board, Commission, and Committee members serve without compensation from the City.
3. No person shall serve at the same time on more than one Board, Commission or Committee.
4. Applicants must be residents of the City of Burbank.
5. Any person appointed to fill a vacancy shall hold office for the remainder of the unexpired term and must complete the term before applying to serve on another board, commission, or committee.
6. Any person appointed to a Board, Commission, or Committee shall remain in compliance with the City's **Attendance Policy**:
 - o In the event a member of a board, commission, or committee is absent for three (3) regularly scheduled meetings of the board, commission, or committee to which they have been appointed during the 12-month period, the attendance record of such member shall be reviewed by the board, commission, or committee to which the member was appointed. Should the Council excuse the member's three absences, and the member misses a fourth meeting, the City Clerk may proceed with the member's automatic removal by City staff. (See BMC Section 2-1-403, 2-1-405, 2-1-406, 2-1-407)

I acknowledge that I have read the above, and by selecting 'Agree' I confirm that I have reviewed and understood the information above.

I Agree

Application Form

Profile

H.

KENNETH SAN MIGUEL

First Name

Middle Initial

SAN MIGUEL

Last Name

[Redacted]

Email Address

[Redacted]

Home Address

Suite or Apt

BURBANK

City

CA
State

91506
Postal Code

[Redacted]

Primary Phone

Alternate Phone

RETIRED

Employer

Job Title

Occupation

Which Boards would you like to apply for?

None Selected

BUILDING CODE & FIRECODE APPEALS BOARD

Length of time as a Burbank Resident: 49 YEARS

Burbank Registered Voter?

Yes No

Interests & Experiences

Please tell us about yourself and why you want to serve.

Why are you interested in serving on a board, commission or committee?

I HAVE BEEN WITH THE PLANNING BOARD FOR 2 TERMS

AND BUILDING CODE APPEALS BOARD FOR 3 YRS.

RETIRED FROM COUNTY SERVICE AS A BUILDING

INSPECTOR

PLEASE SEE MY PRIOR APPLICATIONS FOR OTHER

DETAILS

Community Involvement

Specify current or prior service on a City Board, Commission or Committee, listing specific the specific Board, Commission, or Committee and dates of prior service.:

PLANNING BOARD 2 TERMS } BUILDING CODE APPEALS
List Community activities in which you are involved: BOARD FOR 1 TERM

If you are related to any City of Burbank employee(s), please state their name(s), relationship(s), and department(s). If you are not related to a City of Burbank employee, please put N/A.

Conflict of Interest

Conflict of Interest:

Rules of law and ethics prohibit members from participating in and voting on matters in which they may have a direct or indirect conflict of interest including a financial interest. Are you aware of any potential conflicts of interest which may develop from your occupation or financial holdings in relation to your responsibilities as a member of the Board, Commission or Committee to which you seek appointment?

Yes No

If you answer yes, explain in detail any potential conflicts in the same manner as required by the Fair Political Practices Commission's Statement of Economic Interests (Form 700). (If you should have any questions about this matter or need further information as it relates to your situation, please advise the City Clerk prior to submitting your application.)

AB 1234 Training

Some Boards, Commissions, and Committees may receive City reimbursement for attending trainings or conferences. Therefore, under State Law, all members of the Board of Library Trustees, Burbank Water and Power Board, Infrastructure Oversight Board, Planning Commission, and Police Commission must receive at least two hours of ethics training, as prescribed by the Fair Political Practices Commission, within one year of appointment and once every two years thereafter.

First Choice

FIRST choice for Board/Commission/Committee appointment:

BUILDING CODE APPEAL BOARD

Describe any qualifications, experience, and education, as well as any technical or professional background you may have relative to the duties of this position.

B.S. ARCHITECTURE

What are your goals in serving on this Board/Commission/Committee?

TO LEARN MORE ABOUT CITY ACTIVITIES

Second Choice INFRASTRUCTURES

SECOND choice for Board/Commission/Committee appointment:

SAME AS PRIOR ACTIVITIES IN THE COUNTY INSPECTING
RESIDENTIAL & COMMERCIAL BUILDINGS

Describe any qualifications, experience, and education, as well as any technical or professional background you may have relative to the duties of this position

What are your goals in serving on this Board/Commission/Committee?

KEEP ME MENTALLY ACTIVE AND TO KNOW MORE
ABOUT CITY ACTIVITIES

Supplemental Questions (Infrastructure Oversight Board Only)

Acknowledgment

Please Read

1. All information submitted is a public record and will be posted on the City's website.
2. All Board, Commission, and Committee members serve without compensation from the City.
3. No person shall serve at the same time on more than one Board, Commission or Committee.
4. Applicants must be residents of the City of Burbank.
5. Any person appointed to fill a vacancy shall hold office for the remainder of the unexpired term and must complete the term before applying to serve on another board, commission, or committee.
6. Any person appointed to a Board, Commission, or Committee shall remain in compliance with the City's **Attendance Policy**:
 - In the event a member of a board, commission, or committee is absent for three (3) regularly scheduled meetings of the board, commission, or committee to which they have been appointed during the 12-month period, the attendance record of such member shall be reviewed by the board, commission, or committee to which the member was appointed. Should the Council excuse the member's three absences, and the member misses a fourth meeting, the City Clerk may proceed with the member's automatic removal by City staff. (See BMC Section 2-1-403, 2-1-405, 2-1-406, 2-1-407)

I acknowledge that I have read the above, and by selecting 'Agree' I confirm that I have reviewed and understood the information above.

I Agree